

# Parkview

RECORD OF FRIABLE AND NON-FRIABLE ACM  
(FORM B)

Inspection Date(s) July 31, 2013

THREE-YEAR REINSPECTION

CDS CODE  
04-61424-6003073

SCHOOL  
Parkview Elementary School

SCHOOL PHONE NUMBER  
(530) 891-3114

ADDRESS  
1770 E. Eighth Street

(NUMBER)

(STREET)

(CITY)  
Chico, CA

(ZIP)  
95928

**-IMPORTANT-**

Each building and functional space with friable ACBM or friable assumed ACBM listed on this form requires completion of FORM C (PHYSICAL AND HAZARD ASSESSMENT OF FRIABLE ACBM OR FRIABLE ASSUMED ACBM). Indicate location of material on blueprint, diagram or narrative in square or linear feet, and attach a copy (Sec. 763.93).

LINE	BUILDING NAME & FUNCTIONAL SPACE <small>(Indicate Address if Different From Above)</small>	CHECK ONE			CHECK ONE			
		SUR-FACING	TSI	MISC	ACBM		ASSUMED ACBM	
					FRIABLE	NON-FRIABLE	FRIABLE	NON-FRIABLE
1.	HEALTHY START <b>DISTRICT MUST CERTIFY</b>							
2.	UNIT A - ROOMS 1-2 & 900-902	X		X		X		X
3.	UNIT B - PORTABLE 11A & B			X				X
4.	UNIT C - PORTABLES 12 & 13 <b>DISTRICT MUST CERTIFY</b>							
5.	UNIT D - ROOM 22 <b>DISTRICT MUST CERTIFY</b>							
6.	UNIT E - ROOMS 18-21		X		X			
7.	UNIT F - ROOMS 14-17 & 905-908			X		X		X
8.	RESTROOM ATTIC		X		X			
9.	UNIT G - ROOMS 910-914			X				X
10.	UNIT H - ROOMS 7-10			X				X
11.	UNIT I - ROOMS 914-918	X		X		X		X
12.	UNIT J - ROOMS 3-6			X				X
13.	UNIT K - ROOMS 921-925			X		X		X
14.	UNIT L - ROOMS 23-25 <b>REMOVED FROM SITE</b>							
15.	UNIT M - ROOM 26 <b>DISTRICT MUST CERTIFY</b>							
16.								
17.								

Z:\Clients\Chico USD\13-2751 3 Year Reinspections\Sites\Parkview ES\ParkView Form B.wpd

See attached "Homogeneous Materials Records" for all materials and their locations by building. On Form B all buildings are listed, and a summary of all non-friable and friable material is provided. Friable materials and their locations are listed separately under each building on Form B.

**THREE-YEAR REINSPECTION  
HOMOGENEOUS ACBM RECORDS**

Date of Inspection: July 31, 2013

District: Chico Unified School District

Inspector: Blake Howes

School: Parkview Elementary School

Building: Unit A - Rooms 1-2 & 900-902

Material Class	Material	Homo. Mat. #	% Asb.	Ft <sup>2</sup> /L.F.	Location	Condition: Code & Comments	Friable Yes/No
S	CEILING PLASTER	4	1-5%	150 S	STAFF ROOM/STORAGE	(1) (4)	N
M	12" ACOUSTIC CEILING TILE 1/8" HOLE PATTERN	6	NONE DETECTED	2,800 S	ENTIRE WING	(13) REPRESENTED BY SAMPLE HMS-PKV-06 COLLECTED ON 4-1-88.	N/A
M	CEMENTITIOUS TRANSITE PANELS	99	ASSUMED POSITIVE	70 S	BELOW WINDOWS	(1) (4)	N
M	SHEET VINYL FLOORING & ADHESIVE	100	ASSUMED POSITIVE	80 S	CLASSROOM 1	(12) COULD NOT LOCATE THIS MATERIAL.	N
M	9" VINYL FLOOR TILE (GREEN/WHITE) & ADHESIVE	101	ASSUMED POSITIVE	150 S	OFFICE, HALL, AND STORAGE ROOM	(12) COULD NOT LOCATE THIS MATERIAL.	N
M	12" VINYL FLOOR TILE (WHITE/BLUE) & ADHESIVE	102	ASSUMED POSITIVE	1,500 S	CLASSROOMS 1 & 2	(1) (4)	N
M	12" VINYL FLOOR TILE (OLIVE) & ADHESIVE	103	ASSUMED POSITIVE	70 S	STAFF ROOM/STORAGE	(1) (4)	N
M	COVE BASE ADHESIVE	150	ASSUMED POSITIVE	100 L	CLASSROOMS 1 & 2	(1) (4)	N
S	STUCCO	200	ASSUMED POSITIVE	1,000 S	COVERED WALKWAYS	(1) (4)	N

Z:\Clients\Chico USD\13-2751 3 Year Reinspections\Sites\Parkview ES\ParkView HMR.wpd

**CONDITION CODE**

- General Condition: (1) Good (2) Damaged (3) Significantly Damaged (25% or more)  
Change in Condition: (4) No (5) Yes (If Yes, explain under comments)  
Abated: (6) Repaired (7) Removed (8) Encapsulated (9) Enclosed (10) Isolated & Restricted  
Miscellaneous: (11) Inaccessible, no inspection data (12) Other (Explain under comments) (13) Non-Asbestos/Not Inspected

**CONSULT ORIGINAL AND SUPPLEMENTARY INSPECTION REPORTS FOR MATERIALS WITH TRACE AMOUNTS OF ASBESTOS**

**THREE-YEAR REINSPECTION  
HOMOGENEOUS ACBM RECORDS**

Date of Inspection: July 31, 2013

District: Chico Unified School District

Inspector: Blake Howes

School: Parkview Elementary School

Building: Unit B - Portable 11A & 11B

Material Class	Material	Homo. Mat. #	% Asb.	Ft <sup>2</sup> /L.F.	Location	Condition: Code & Comments	Friable Yes/No
M	12" VINYL FLOOR TILE (CREAM) & ADHESIVE	12	ASSUMED POSITIVE	120 S	CLASSROOMS 11A & 11B	(1) (4)	N
M	2' X 4' CEILING PANEL - FISSURE PATTERN	14	ASSUMED POSITIVE	900 S	CLASSROOMS 11A & 11B	(1) (4)	N
M	COVE BASE ADHESIVE	150	ASSUMED POSITIVE	60 L	CLASSROOMS 11A & 11B	(1) (4)	N
M	CARPET ADHESIVE	151	ASSUMED POSITIVE	180 S	CLASSROOMS 11A & 11B	(1) (4)	N
M	DRYWALL & TAGBOARD	201	ASSUMED POSITIVE	2,000 S	CLASSROOMS 11A & 11B	(11) DRYWALL ASSUMED TO EXIST BENEATH TAGBOARD WALL COVERING	N

Z:\Clients\Chico USD\13-2751 3 Year Reinspections\Sites\Parkview ES\ParkView HMR.wpd

**CONDITION CODE**

- General Condition: (1) Good (2) Damaged (3) Significantly Damaged (25% or more)  
Change in Condition: (4) No (5) Yes (If Yes, explain under comments)  
Abated: (6) Repaired (7) Removed (8) Encapsulated (9) Enclosed (10) Isolated & Restricted  
Miscellaneous: (11) Inaccessible, no inspection data (12) Other (Explain under comments) (13) Non-Asbestos/Not Inspected

**CONSULT ORIGINAL AND SUPPLEMENTARY INSPECTION REPORTS FOR MATERIALS WITH TRACE AMOUNTS OF ASBESTOS**

**THREE-YEAR REINSPECTION  
HOMOGENEOUS ACBM RECORDS**

Date of Inspection: July 31, 2013

District: Chico Unified School District

Inspector: Blake Howes

School: Parkview Elementary School

Building: Unit E - Rooms 18-21

Material Class	Material	Homo. Mat. #	% Asb.	Ft <sup>2</sup> /L.F.	Location	Condition: Code & Comments	Friable Yes/No
M	2' X 4' CEILING PANELS	17	NONE DETECTED	3,800 S	CLASSROOMS 18-21	(13) SAMPLE HMS-PKV-17 COLLECTED ON 4-1-88.	N/A
T	PIPE WRAP CORNER	18	5-10%	20 S	CLASSROOM 18	(1) ABOVE CEILING PANELS. SAMPLE HMS-PKV-18 COLLECTED ON 4-1-88.	Y
M	12" VINYL FLOOR TILE (WHITE/BLUE) & ADHESIVE	16	ASSUMED POSITIVE	4,000 S	CLASSROOMS 18-21	(1) (4)	N
M	COVE BASE ADHESIVE	150	ASSUMED POSITIVE	480 L	CLASSROOMS 18-21	(1) (4)	N
S	STUCCO	200	ASSUMED POSITIVE	1,500 S	COVERED WALKWAYS	(1) (4)	N
M	DRYWALL & JOINT COMPOUND	202	ASSUMED POSITIVE	4,000 S	CLASSROOMS 18-21	(1) (4)	N

Z:\Clients\Chico USD\13-2751 3 Year Reinspections\Sites\Parkview ES\ParkView HMR.wpd

**CONDITION CODE**

General Condition: (1) Good (2) Damaged (3) Significantly Damaged (25% or more)

Change in Condition: (4) No (5) Yes (If Yes, explain under comments)

Abated: (6) Repaired (7) Removed (8) Encapsulated (9) Enclosed (10) Isolated & Restricted

Miscellaneous: (11) Inaccessible, no inspection data (12) Other (Explain under comments) (13) Non-Asbestos/Not Inspected

**CONSULT ORIGINAL AND SUPPLEMENTARY INSPECTION REPORTS FOR MATERIALS WITH TRACE AMOUNTS OF ASBESTOS**

**THREE-YEAR REINSPECTION  
HOMOGENEOUS ACBM RECORDS**

Date of Inspection: July 31, 2013

District: Chico Unified School District

Inspector: Blake Howes

School: Parkview Elementary School

Building: Unit F - Rooms 14-17 & 905-908

Material Class	Material	Homo. Mat. #	% Asb.	Ft <sup>2</sup> /L.F.	Location	Condition: Code & Comments	Friable Yes/No
M	2' X 4' CEILING PANEL - FISSURE PATTERN	12	NONE DETECTED	4,500 S	CLASSROOMS 14-17 & LIBRARY	(13) SAMPLE HMS-PKV-12 COLLECTED ON 3-31-88.	N/A
M	9" VINYL FLOOR TILE (CREAM MOTTLED) & ADHESIVE	13	1-5%	5,000 S	CLASSROOMS 14-17 AND SER ROOM (906)	(2) (5) SER ROOM (906) HAS SMALL CRACKS.	N
T	PIPE WRAP CORNER	15	1-5%	12 EACH	RESTROOM ATTIC	(1)	Y
M	DRYWALL	76	TRACE IN SKIM COAT	3,000 S	ALL ROOMS	(1) (4) CLASSROOMS & LIBRARY HAVE TAG BOARD WALLS.	N
M	12" ACOUSTIC CEILING TILE - FISSURE PATTERN	97	ASSUMED POSITIVE	250 S	SER ROOM (906)	(1) (4)	N
M	12" VINYL FLOOR TILE (LIGHT GREY MOTTLED) & ADHESIVE	100	ASSUMED POSITIVE	250 S	LIBRARY	(1) (4)	N
M	COVE BASE ADHESIVE	150	ASSUMED POSITIVE	400 L	CLASSROOMS 14-17, LIBRARY, & ROOM 906	(1) (4)	N
M	CARPET ADHESIVE	151	ASSUMED POSITIVE	900 S	LIBRARY	(1) (4)	N
S	STUCCO	200	ASSUMED POSITIVE	1,500 S	COVERED WALKWAYS	(1) (4)	N

Z:\Clients\Chico USD\13-2751 3 Year Reinspections\Sites\Parkview ES\ParkView HMR.wpd

**CONDITION CODE**

- General Condition:** (1) Good (2) Damaged (3) Significantly Damaged (25% or more)  
**Change in Condition:** (4) No (5) Yes (If Yes, explain under comments)  
**Abated:** (6) Repaired (7) Removed (8) Encapsulated (9) Enclosed (10) Isolated & Restricted  
**Miscellaneous:** (11) Inaccessible, no inspection data (12) Other (Explain under comments) (13) Non-Asbestos/Not Inspected

**CONSULT ORIGINAL AND SUPPLEMENTARY INSPECTION REPORTS FOR MATERIALS WITH TRACE AMOUNTS OF ASBESTOS**

**THREE-YEAR REINSPECTION  
HOMOGENEOUS ACBM RECORDS**

Date of Inspection: July 31, 2013

District: Chico Unified School District

Inspector: Blake Howes

School: Parkview Elementary School

Building: Unit G - Rooms 910-914

Material Class	Material	Homo. Mat. #	% Asb.	Ft <sup>2</sup> /L.F.	Location	Condition: Code & Comments	Friable Yes/No
M	12" ACOUSTIC CEILING TILE	85	ASSUMED POSITIVE	700 S	OFFICE CORRIDOR	(1) (4)	N
M	12" VINYL FLOOR TILE (WHITE/BLUE) & ADHESIVE	86	ASSUMED POSITIVE	3,000 S	3 OFFICES, SPEECH ROOM, OFFICE CORRIDOR, NURSE, AND STAFF LOUNGE	(1) (4) (11) COVERED WITH CARPET IN SPEECH ROOM.	N
M	CEMENTITIOUS TRANSITE PANELS	99	ASSUMED POSITIVE	1,000 S	BELOW WINDOWS	(1) (4)	N
M	12" VINYL FLOOR TILE (BLUE) & ADHESIVE	104	ASSUMED POSITIVE	200 S	ADMINISTRATION OFFICE	(1) (4)	N
M	COVE BASE ADHESIVE	150	ASSUMED POSITIVE	500 L	SPEECH (910), OFFICES 911-914, & NURSE	(1) (4)	N
M	CARPET ADHESIVE	151	ASSUMED POSITIVE	300 S	ROOMS 911 & 914	(1) (4)	N
M	COVE BASE ADHESIVE	152	ASSUMED POSITIVE	100 L	OFFICES 911, 912, & 914	(1) (4)	N
S	STUCCO	200	ASSUMED POSITIVE	1,500 S	COVERED WALKWAYS	(1) (4)	N
M	SHEET VINYL FLOORING (CREAM) & ADHESIVE	250	ASSUMED POSITIVE	25 S	NURSE RESTROOM (912A)	(1) (4)	N

Z:\Clients\Chico USD\13-2751 3 Year Reinspections\Sites\Parkview ES\ParkView HMR.wpd

**CONDITION CODE**

**General Condition:** (1) Good (2) Damaged (3) Significantly Damaged (25% or more)  
**Change in Condition:** (4) No (5) Yes (If Yes, explain under comments)  
**Abated:** (6) Repaired (7) Removed (8) Encapsulated (9) Enclosed (10) Isolated & Restricted  
**Miscellaneous:** (11) Inaccessible, no inspection data (12) Other (Explain under comments) (13) Non-Asbestos/Not Inspected

**CONSULT ORIGINAL AND SUPPLEMENTARY INSPECTION REPORTS FOR MATERIALS WITH TRACE AMOUNTS OF ASBESTOS**

**THREE-YEAR REINSPECTION  
HOMOGENEOUS ACBM RECORDS**

Date of Inspection: July 31, 2013

District: Chico Unified School District

Inspector: Blake Howes

School: Parkview Elementary School

Building: Unit H - Rooms 7-10

Material Class	Material	Homo. Mat. #	% Asb.	Ft <sup>2</sup> /L.F.	Location	Condition: Code & Comments	Friable Yes/No
M	DRYWALL	82	ASSUMED POSITIVE	800 S	MEN'S & WOMEN'S RESTROOMS	(1) (4)	N
M	12" VINYL FLOOR TILE (WHITE/BLUE) & ADHESIVE	86	ASSUMED POSITIVE	1,000 S	CLASSROOMS 7-10	(1) (4)	N
M	2' X 4' CEILING PANEL - FISSURE PATTERN	87	ASSUMED POSITIVE	2,600 S	CLASSROOMS 7-10	(1) (4)	N
M	CEMENTITIOUS TRANSITE PANELS	99	ASSUMED POSITIVE	400 S	BELOW EXTERIOR WINDOWS	(1) (4)	N
M	12" ACOUSTIC CEILING TILE - 1/8" HOLE PAT.	105	ASSUMED POSITIVE	400 S	CLASSROOMS 7-10	(1) (4)	N
M	SHEET VINYL FLOORING (CREAM) & ADHESIVE	106	ASSUMED POSITIVE	200 S	MEN'S & WOMEN'S RESTROOMS	(1) (4)	N
M	COVE BASE ADHESIVE	250	ASSUMED POSITIVE	400 L	CLASSROOMS 7-10	(1) (4)	N
M	CARPET ADHESIVE	251	ASSUMED POSITIVE	2,800 S	CLASSROOMS 7-10	(1) (4)	N

Z:\Clients\Chico USD\13-2751 3 Year Reinspections\Sites\Parkview ES\ParkView HMR.wpd

**CONDITION CODE**

General Condition: (1) Good (2) Damaged (3) Significantly Damaged (25% or more)  
Change in Condition: (4) No (5) Yes (If Yes, explain under comments)  
Abated: (6) Repaired (7) Removed (8) Encapsulated (9) Enclosed (10) Isolated & Restricted  
Miscellaneous: (11) Inaccessible, no inspection data (12) Other (Explain under comments) (13) Non-Asbestos/Not Inspected

**CONSULT ORIGINAL AND SUPPLEMENTARY INSPECTION REPORTS FOR MATERIALS WITH TRACE AMOUNTS OF ASBESTOS**



**THREE-YEAR REINSPECTION  
HOMOGENEOUS ACBM RECORDS**

Date of Inspection: July 31, 2013

District: Chico Unified School District

Inspector: Blake Howes

School: Parkview Elementary School

Building: Unit I - Rooms 914-918

Material Class	Material	Homo. Mat. #	% Asb.	Ft <sup>2</sup> /L.F.	Location	Condition: Code & Comments	Friable Yes/No
S	PLASTER	4	1-5%	1,100 S	BOY'S & GIRL'S RESTROOM WALLS AND CUSTODIAN ROOM	(1) (4) (2) (4) MINOR DAMAGE IN THE CUSTODIAL ROOM.	N
M	DRYWALL	83	ASSUMED POSITIVE	300 S	BOY'S & GIRL'S RESTROOM CEILING	(1) (4)	N

Z:\Clients\Chico USD\13-2751 3 Year Reinspections\Sites\Parkview ES\ParkView HMR.wpd

CONDITION CODE

General Condition: (1) Good (2) Damaged (3) Significantly Damaged (25% or more)

Change in Condition: (4) No (5) Yes (If Yes, explain under comments)

Abated: (6) Repaired (7) Removed (8) Encapsulated (9) Enclosed (10) Isolated & Restricted

Miscellaneous: (11) Inaccessible, no inspection data (12) Other (Explain under comments) (13) Non-Asbestos/Not Inspected

**CONSULT ORIGINAL AND SUPPLEMENTARY INSPECTION REPORTS FOR MATERIALS WITH TRACE AMOUNTS OF ASBESTOS**

**THREE-YEAR REINSPECTION  
HOMOGENEOUS ACBM RECORDS**

Date of Inspection: July 31, 2013

District: Chico Unified School District

Inspector: Blake Howes

School: Parkview Elementary School

Building: Unit J - Rooms 3-6

Material Class	Material	Homo. Mat. #	% Asb.	Ft <sup>2</sup> /L.F.	Location	Condition: Code & Comments	Friable Yes/No
M	12" VINYL FLOOR TILE (WHITE/BLUE) & ADHESIVE	86	ASSUMED POSITIVE	1,000 S	CLASSROOMS 3-6 AND WORKROOM	(1) (4)	N
M	2' X 4' CEILING PANELS	87	ASSUMED POSITIVE	3,200 S	CLASSROOMS 3-6	(1) (4)	N
M	CEMENTITIOUS TRANSITE PANELS	99	ASSUMED POSITIVE	400 S	BELOW WINDOWS	(1) (4)	N
M	12" ACOUSTIC CEILING TILE	107	ASSUMED POSITIVE	400 S	CLASSROOMS 3-6	(1) (4)	N
M	DRYWALL & JOINT COMPOUND	108	ASSUMED POSITIVE	1,200 S	COPY ROOM AND CUSTODIAL ROOM	(1) (4)	N
M	COVE BASE ADHESIVE	250	ASSUMED POSITIVE	400 L	CLASSROOMS 3-6 & WORKROOM	(1) (4)	N
M	CARPET ADHESIVE	251	ASSUMED POSITIVE	2,800 S	CLASSROOMS 3-6	(1) (4)	N

Z:\Clients\Chico USD\13-2751 3 Year Reinspections\Sites\Parkview ES\ParkView HMR.wpd

**CONDITION CODE**

- General Condition: (1) Good (2) Damaged (3) Significantly Damaged (25% or more)  
Change in Condition: (4) No (5) Yes (If Yes, explain under comments)  
Abated: (6) Repaired (7) Removed (8) Encapsulated (9) Enclosed (10) Isolated & Restricted  
Miscellaneous: (11) Inaccessible, no inspection data (12) Other (Explain under comments) (13) Non-Asbestos/Not Inspected

**CONSULT ORIGINAL AND SUPPLEMENTARY INSPECTION REPORTS FOR MATERIALS WITH TRACE AMOUNTS OF ASBESTOS**

**THREE-YEAR REINSPECTION  
HOMOGENEOUS ACBM RECORDS**

Date of Inspection: July 31, 2013

District: Chico Unified School District

Inspector: Blake Howes

School: Parkview Elementary School

Building: Unit K- Rooms 921-925

Material Class	Material	Homo. Mat. #	% Asb.	Ft <sup>2</sup> /L.F.	Location	Condition: Code & Comments	Friable Yes/No
S	PLASTER	3	NONE DETECTED	1,200 S	KITCHEN	(13) REPRESENTED BY SAMPLES HMS-PKV-03A-F COLLECTED ON 4-1-88.	N/A
M	12" VINYL FLOOR TILE (RED) & ADHESIVE	9	1-5%	540 S	KITCHEN (NORTH WEST CORNER)	(1) (4)	N
M	DRYWALL & JOINT COMPOUND	11	ASSUMED POSITIVE	60 S	GIRL'S & BOY'S RESTROOM CEILINGS	(1) (4)	N
M	12" VINYL FLOOR TILE (WHITE/BLUE) & ADHESIVE	92	ASSUMED POSITIVE	1,800 S	MPR, KITCHEN, AND CLOSET ON EACH END OF STAGE	(1) (4)	N
M	9" VINYL FLOOR TILE (BEIGE) & ADHESIVE	101	ASSUMED POSITIVE	200 S	KITCHEN STORAGE	(2) (5) MISSING TILE AND BROKEN TILES.	N
M	COVE BASE ADHESIVE	150	ASSUMED POSITIVE	100 S	MPR AND KITCHEN	(1) (4)	N
S	STUCCO	200	ASSUMED POSITIVE	500 S	COVERED WALKWAYS	(1) (4)	N

Z:\Clients\Chico USD\13-2751 3 Year Reinspections\Sites\Parkview ES\ParkView HMR.wpd

**CONDITION CODE**

General Condition: (1) Good (2) Damaged (3) Significantly Damaged (25% or more)

Change in Condition: (4) No (5) Yes (If Yes, explain under comments)

Abated: (6) Repaired (7) Removed (8) Encapsulated (9) Enclosed (10) Isolated & Restricted

Miscellaneous: (11) Inaccessible, no inspection data (12) Other (Explain under comments) (13) Non-Asbestos/Not Inspected

**CONSULT ORIGINAL AND SUPPLEMENTARY INSPECTION REPORTS FOR MATERIALS WITH TRACE AMOUNTS OF ASBESTOS**

**ENTEK CONSULTING GROUP, INC.  
ASSESSMENT OF TSI and/or FRIABLE MATERIAL**

District: Chico Unified School District

Date: July 31, 2013

School: Parkview Elementary School

Inspector: Blake Howes

Building & Location(s): Unit F - Rooms 14-17 & 905-908

Unknown Sample #'s

% Asbestos- 1-5%

Homogeneous Mat. #15

Material description: Pipe Wrap Corner

Total amount of material this location: 12 Each

Amount of friable material this location: 12 Each

Damage	Local		Distributed		Damaged	0%
Type of Damage	Air Erosion		Water		Flaking	
	Deterioration		Physical		Delamination	

Probable cause(s) of damage: Physical Damage

POTENTIAL FOR DISTURBANCE			RESPONSE ACTIONS		PREVENTIVE MEASURES	
	H	M	L			
				Isolate/Restrict		Fix leaks
Accessibility			X	Repair/Cleanup		Prevent water contact
Vibration			X	Enclose		Do not drill, cut, sand, or grind
Air Erosion			X	Remove		Do not affix signs
Water			X	Encapsulate		Avoid contact
Occupancy			X	O & M	X	

**Assessment of Material Condition**

Significantly Damaged  
(Poor)

Damaged  
(Fair)

Not damaged  
(Good)



Potential Damage: High

High Mod Low

High Mod Low

Hazard Ranking:

1 2 3 4 5 6 7

								X
--	--	--	--	--	--	--	--	---

Comments & Observations:

**ENTEK CONSULTING GROUP, INC.  
ASSESSMENT OF TSI and/or FRIABLE MATERIAL**

District: Chico Unified School District

Date: July 31, 2013

School: Parkview Elementary School

Inspector: Blake Howes

Building & Location(s): Unit F - Rooms 14-17 & 905-908

Unknown Sample #'s

% Asbestos- 1-5%

Homogeneous Mat. #15

Material description: Pipe Wrap Corner

Total amount of material this location: 12 Each

Amount of friable material this location: 12 Each

Damage	Local		Distributed		Damaged	0%
Type of Damage	Air Erosion		Water		Flaking	
	Deterioration		Physical		Delamination	

Probable cause(s) of damage: Physical Damage

POTENTIAL FOR DISTURBANCE			RESPONSE ACTIONS		PREVENTIVE MEASURES	
	H	M	L	Isolate/Restrict		Fix leaks
Accessibility			X	Repair/Cleanup		Prevent water contact
Vibration			X	Enclose		Do not drill, cut, sand, or grind
Air Erosion			X	Remove		Do not affix signs
Water			X	Encapsulate		Avoid contact
Occupancy			X	O & M	X	

**Assessment of Material Condition**

Significantly Damaged  
(Poor)

Damaged  
(Fair)

Not damaged  
(Good)



Potential Damage: High

High Mod Low

High Mod Low

Hazard Ranking:

1 2 3 4 5 6 7

								X
--	--	--	--	--	--	--	--	---

Comments & Observations:

**ENTEK CONSULTING GROUP, INC.  
ASSESSMENT OF TSI and/or FRIABLE MATERIAL**

District: Chico Unified School District

Date: July 31, 2013

School: Parkview Elementary School

Inspector: Blake Howes

Building & Location(s): Unit E - Rooms 18-21, Classroom 18

HMS-PKV-18

% Asbestos-5-10%

Homogeneous Mat. #18

Material description: Pipe Wrap Corner

Total amount of material this location: 20 S

Amount of friable material this location: 20 S

Damage	Local		Distributed		Damaged	0%
Type of Damage	Air Erosion		Water		Flaking	
	Deterioration		Physical		Delamination	

Probable cause(s) of damage: Physical Damage

POTENTIAL FOR DISTURBANCE			RESPONSE ACTIONS		PREVENTIVE MEASURES	
	H	M	L			
				Isolate/Restrict		Fix leaks
Accessibility			X	Repair/Cleanup		Prevent water contact
Vibration			X	Enclose		Do not drill, cut, sand, or grind
Air Erosion			X	Remove		Do not affix signs
Water			X	Encapsulate		Avoid contact
Occupancy			X	O & M	X	

**Assessment of Material Condition**

Significantly Damaged  
(Poor)

Damaged  
(Fair)

Not damaged  
(Good)



Potential Damage: High

High Mod Low

High Mod Low

Hazard Ranking:

1 2 3 4 5 6 7

								X
--	--	--	--	--	--	--	--	---

Comments & Observations:



# Parkview Elementary School

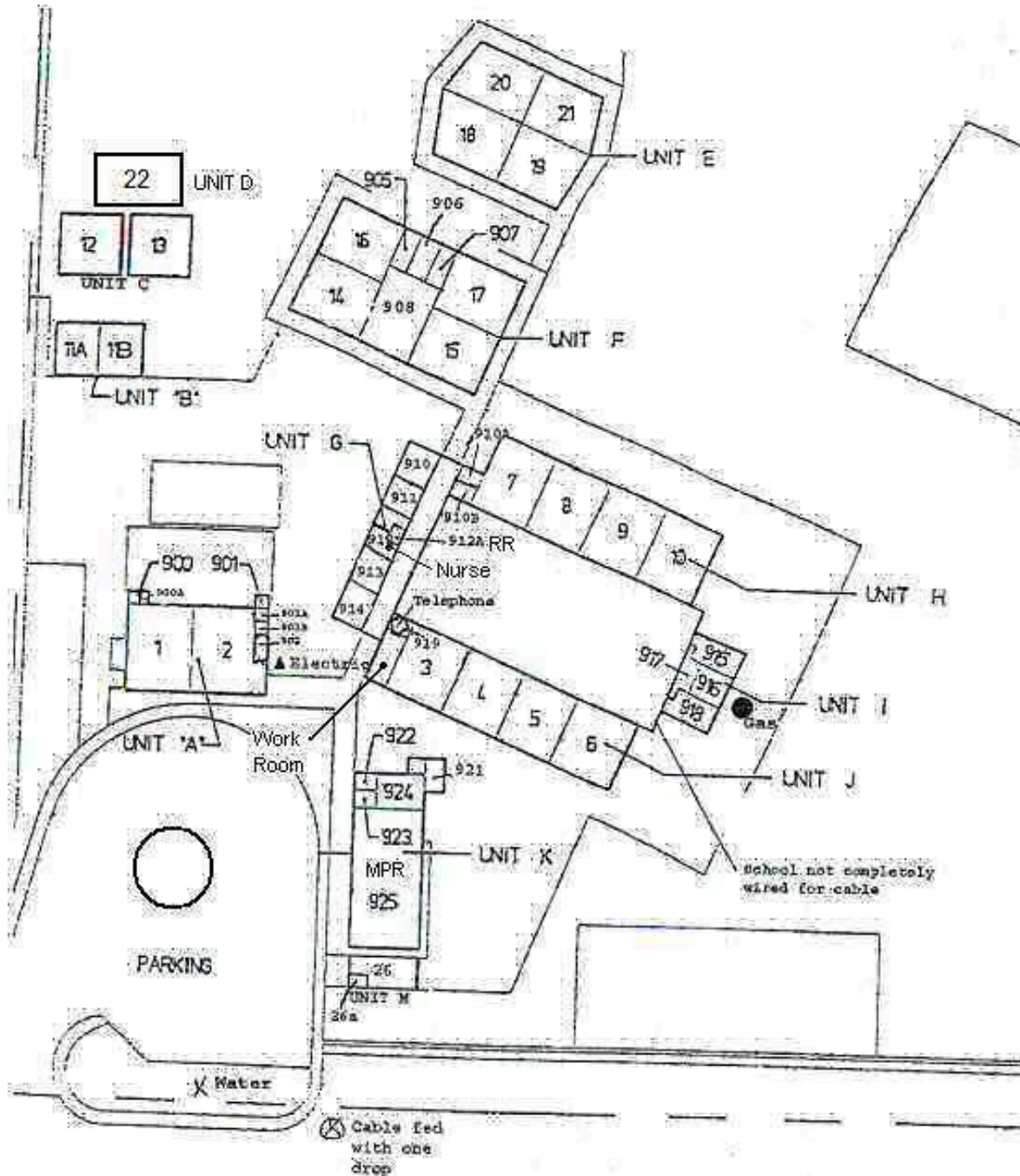

*Blake Howes*

Chico Unified School District  
Parkview Elementary School  
1770 E. Eighth Street  
Chico, CA 95928

Entek Consulting Group, Inc.  
4200 Rocklin Road, Suite 7  
Rocklin, California 95677  
Map Not To Scale

3-Year AHERA Reinspection  
Conducted by Blake Howes  
July 31, 2013  
Project 13-2751

# **SIX-MONTH SURVEILLANCE**



**SIX MONTH SURVEILLANCE  
HOMOGENEOUS ACBM RECORDS**

Date of Inspection: July 31, 2013

District: Chico Unified School District

Inspector: Blake Howes

School: Parkview Elementary School

Building: Unit A - Rooms 1-2 & 900-902

Material Class	Material	Homo. Mat. #	% Asb.	Ft <sup>2</sup> /L.F.	Location	Condition: Code & Comments	Friable Yes/No
S	CEILING PLASTER	4	1-5%	150 S	STAFF ROOM/STORAGE	(1) (4)	N
M	12" ACOUSTIC CEILING TILE 1/8" HOLE PATTERN	6	NONE DETECTED	2,800 S	ENTIRE WING	(13) REPRESENTED BY SAMPLE HMS-PKV-06 COLLECTED ON 4-1-88.	N/A
M	CEMENTITIOUS TRANSITE PANELS	99	ASSUMED POSITIVE	70 S	BELOW WINDOWS	(1) (4)	N
M	SHEET VINYL FLOORING & ADHESIVE	100	ASSUMED POSITIVE	80 S	CLASSROOM 1	(12) COULD NOT LOCATE THIS MATERIAL.	N
M	9" VINYL FLOOR TILE (GREEN/WHITE) & ADHESIVE	101	ASSUMED POSITIVE	150 S	OFFICE, HALL, AND STORAGE ROOM	(12) COULD NOT LOCATE THIS MATERIAL.	N
M	12" VINYL FLOOR TILE (WHITE/BLUE) & ADHESIVE	102	ASSUMED POSITIVE	1,500 S	CLASSROOMS 1 & 2	(1) (4)	N
M	12" VINYL FLOOR TILE (OLIVE) & ADHESIVE	103	ASSUMED POSITIVE	70 S	STAFF ROOM/STORAGE	(1) (4)	N
M	COVE BASE ADHESIVE	150	ASSUMED POSITIVE	100 L	CLASSROOMS 1 & 2	(1) (4)	N
S	STUCCO	200	ASSUMED POSITIVE	1,000 S	COVERED WALKWAYS	(1) (4)	N

Z:\Clients\Chico USD\13-2751 3 Year Reinspections\Sites\Parkview ES\ParkView 6 MONTH.wpd

**CONDITION CODE**

General Condition: (1) Good (2) Damaged (3) Significantly Damaged (25% or more)

Change in Condition: (4) No (5) Yes (If Yes, explain under comments)

Abated: (6) Repaired (7) Removed (8) Encapsulated (9) Enclosed (10) Isolated & Restricted

Miscellaneous: (11) Inaccessible, no inspection data (12) Other (Explain under comments) (13) Non-Asbestos/Not Inspected

**CONSULT ORIGINAL AND SUPPLEMENTARY INSPECTION REPORTS FOR MATERIALS WITH TRACE AMOUNTS OF ASBESTOS**

**SIX MONTH SURVEILLANCE  
HOMOGENEOUS ACBM RECORDS**

Date of Inspection: July 31, 2013

District: Chico Unified School District

Inspector: Blake Howes

School: Parkview Elementary School

Building: Unit B - Portable 11A & 11B

Material Class	Material	Homo. Mat. #	% Asb.	Ft <sup>2</sup> /L.F.	Location	Condition: Code & Comments	Friable Yes/No
M	12" VINYL FLOOR TILE (CREAM) & ADHESIVE	12	ASSUMED POSITIVE	120 S	CLASSROOMS 11A & 11B	(1) (4)	N
M	2' X 4' CEILING PANEL - FISSURE PATTERN	14	ASSUMED POSITIVE	900 S	CLASSROOMS 11A & 11B	(1) (4)	N
M	COVE BASE ADHESIVE	150	ASSUMED POSITIVE	60 L	CLASSROOMS 11A & 11B	(1) (4)	N
M	CARPET ADHESIVE	151	ASSUMED POSITIVE	180 S	CLASSROOMS 11A & 11B	(1) (4)	N
M	DRYWALL & TAGBOARD	201	ASSUMED POSITIVE	2,000 S	CLASSROOMS 11A & 11B	(11) DRYWALL ASSUMED TO EXIST BENEATH TAGBOARD WALL COVERING	N

Z:\Clients\Chico USD\13-2751 3 Year Reinspections\Sites\Parkview ES\ParkView 6 MONTH.wpd

**CONDITION CODE**

General Condition: (1) Good (2) Damaged (3) Significantly Damaged (25% or more)

Change in Condition: (4) No (5) Yes (If Yes, explain under comments)

Abated: (6) Repaired (7) Removed (8) Encapsulated (9) Enclosed (10) Isolated & Restricted

Miscellaneous: (11) Inaccessible, no inspection data (12) Other (Explain under comments) (13) Non-Asbestos/Not Inspected

**CONSULT ORIGINAL AND SUPPLEMENTARY INSPECTION REPORTS FOR MATERIALS WITH TRACE AMOUNTS OF ASBESTOS**

**SIX MONTH SURVEILLANCE  
HOMOGENEOUS ACBM RECORDS**

Date of Inspection: July 31, 2013

District: Chico Unified School District

Inspector: Blake Howes

School: Parkview Elementary School

Building: Unit E - Rooms 18-21

Material Class	Material	Homo. Mat. #	% Asb.	Ft <sup>2</sup> /L.F.	Location	Condition: Code & Comments	Friable Yes/No
M	2' X 4' CEILING PANELS	17	NONE DETECTED	3,800 S	CLASSROOMS 18-21	(13) SAMPLE HMS-PKV-17 COLLECTED ON 4-1-88.	N/A
T	PIPE WRAP CORNER	18	5-10%	20 S	CLASSROOM 18	(1) ABOVE CEILING PANELS. SAMPLE HMS-PKV-18 COLLECTED ON 4-1-88.	Y
M	12" VINYL FLOOR TILE (WHITE/BLUE) & ADHESIVE	16	ASSUMED POSITIVE	4,000 S	CLASSROOMS 18-21	(1) (4)	N
M	COVE BASE ADHESIVE	150	ASSUMED POSITIVE	480 L	CLASSROOMS 18-21	(1) (4)	N
S	STUCCO	200	ASSUMED POSITIVE	1,500 S	COVERED WALKWAYS	(1) (4)	N
M	DRYWALL & JOINT COMPOUND	202	ASSUMED POSITIVE	4,000 S	CLASSROOMS 18-21	(1) (4)	N

Z:\Clients\Chico USD\13-2751 3 Year Reinspections\Sites\Parkview ES\ParkView 6 MONTH.wpd

**CONDITION CODE**

General Condition: (1) Good (2) Damaged (3) Significantly Damaged (25% or more)  
Change in Condition: (4) No (5) Yes (If Yes, explain under comments)  
Abated: (6) Repaired (7) Removed (8) Encapsulated (9) Enclosed (10) Isolated & Restricted  
Miscellaneous: (11) Inaccessible, no inspection data (12) Other (Explain under comments) (13) Non-Asbestos/Not Inspected

**CONSULT ORIGINAL AND SUPPLEMENTARY INSPECTION REPORTS FOR MATERIALS WITH TRACE AMOUNTS OF ASBESTOS**

**SIX MONTH SURVEILLANCE  
HOMOGENEOUS ACBM RECORDS**

Date of Inspection: July 31, 2013

District: Chico Unified School District

Inspector: Blake Howes

School: Parkview Elementary School

Building: Unit F - Rooms 14-17 & 905-908

Material Class	Material	Homo. Mat. #	% Asb.	Ft <sup>2</sup> /L.F.	Location	Condition: Code & Comments	Friable Yes/No
M	2' X 4' CEILING PANEL - FISSURE PATTERN	12	NONE DETECTED	4,500 S	CLASSROOMS 14-17 & LIBRARY	(13) SAMPLE HMS-PKV-12 COLLECTED ON 3-31-88.	N/A
M	9" VINYL FLOOR TILE (CREAM MOTTLED) & ADHESIVE	13	1-5%	5,000 S	CLASSROOMS 14-17 AND SER ROOM (906)	(2) (5) SER ROOM (906) HAS SMALL CRACKS.	N
T	PIPE WRAP CORNER	15	1-5%	12 EACH	RESTROOM ATTIC	(1)	Y
M	DRYWALL	76	TRACE IN SKIM COAT	3,000 S	ALL ROOMS	(1) (4) CLASSROOMS & LIBRARY HAVE TAG BOARD WALLS.	N
M	12" ACOUSTIC CEILING TILE - FISSURE PATTERN	97	ASSUMED POSITIVE	250 S	SER ROOM (906)	(1) (4)	N
M	12" VINYL FLOOR TILE (LIGHT GREY MOTTLED) & ADHESIVE	100	ASSUMED POSITIVE	250 S	LIBRARY	(1) (4)	N
M	COVE BASE ADHESIVE	150	ASSUMED POSITIVE	400 L	CLASSROOMS 14-17, LIBRARY, & ROOM 906	(1) (4)	N
M	CARPET ADHESIVE	151	ASSUMED POSITIVE	900 S	LIBRARY	(1) (4)	N
S	STUCCO	200	ASSUMED POSITIVE	1,500 S	COVERED WALKWAYS	(1) (4)	N

Z:\Clients\Chico USD\13-2751 3 Year Reinspections\Sites\Parkview ES\ParkView 6 MONTH.wpd

**CONDITION CODE**

**General Condition:** (1) Good (2) Damaged (3) Significantly Damaged (25% or more)

**Change in Condition:** (4) No (5) Yes (If Yes, explain under comments)

**Abated:** (6) Repaired (7) Removed (8) Encapsulated (9) Enclosed (10) Isolated & Restricted

**Miscellaneous:** (11) Inaccessible, no inspection data (12) Other (Explain under comments) (13) Non-Asbestos/Not Inspected

**CONSULT ORIGINAL AND SUPPLEMENTARY INSPECTION REPORTS FOR MATERIALS WITH TRACE AMOUNTS OF ASBESTOS**

**SIX MONTH SURVEILLANCE  
HOMOGENEOUS ACBM RECORDS**

Date of Inspection: July 31, 2013

District: Chico Unified School District

Inspector: Blake Howes

School: Parkview Elementary School

Building: Unit G - Rooms 910-914

Material Class	Material	Homo. Mat. #	% Asb.	Ft <sup>2</sup> /L.F.	Location	Condition: Code & Comments	Friable Yes/No
M	12" ACOUSTIC CEILING TILE	85	ASSUMED POSITIVE	700 S	OFFICE CORRIDOR	(1) (4)	N
M	12" VINYL FLOOR TILE (WHITE/BLUE) & ADHESIVE	86	ASSUMED POSITIVE	3,000 S	3 OFFICES, SPEECH ROOM, OFFICE CORRIDOR, NURSE, AND STAFF LOUNGE	(1) (4) (11) COVERED WITH CARPET IN SPEECH ROOM.	N
M	CEMENTITIOUS TRANSITE PANELS	99	ASSUMED POSITIVE	1,000 S	BELOW WINDOWS	(1) (4)	N
M	12" VINYL FLOOR TILE (BLUE) & ADHESIVE	104	ASSUMED POSITIVE	200 S	ADMINISTRATION OFFICE	(1) (4)	N
M	COVE BASE ADHESIVE	150	ASSUMED POSITIVE	500 L	SPEECH (910), OFFICES 911-914, & NURSE	(1) (4)	N
M	CARPET ADHESIVE	151	ASSUMED POSITIVE	300 S	ROOMS 911 & 914	(1) (4)	N
M	COVE BASE ADHESIVE	152	ASSUMED POSITIVE	100 L	OFFICES 911, 912, & 914	(1) (4)	N
S	STUCCO	200	ASSUMED POSITIVE	1,500 S	COVERED WALKWAYS	(1) (4)	N
M	SHEET VINYL FLOORING (CREAM) & ADHESIVE	250	ASSUMED POSITIVE	25 S	NURSE RESTROOM (912A)	(1) (4)	N

Z:\Clients\Chico USD\13-2751 3 Year Reinspections\Sites\Parkview ES\ParkView 6 MONTH.wpd

**CONDITION CODE**

General Condition: (1) Good (2) Damaged (3) Significantly Damaged (25% or more)

Change in Condition: (4) No (5) Yes (If Yes, explain under comments)

Abated: (6) Repaired (7) Removed (8) Encapsulated (9) Enclosed (10) Isolated & Restricted

Miscellaneous: (11) Inaccessible, no inspection data (12) Other (Explain under comments) (13) Non-Asbestos/Not Inspected

**CONSULT ORIGINAL AND SUPPLEMENTARY INSPECTION REPORTS FOR MATERIALS WITH TRACE AMOUNTS OF ASBESTOS**

**SIX MONTH SURVEILLANCE  
HOMOGENEOUS ACBM RECORDS**

Date of Inspection: July 31, 2013

District: Chico Unified School District

Inspector: Blake Howes

School: Parkview Elementary School

Building: Unit H - Rooms 7-10

Material Class	Material	Homo. Mat. #	% Asb.	Ft <sup>2</sup> /L.F.	Location	Condition: Code & Comments	Friable Yes/No
M	DRYWALL	82	ASSUMED POSITIVE	800 S	MEN'S & WOMEN'S RESTROOMS	(1) (4)	N
M	12" VINYL FLOOR TILE (WHITE/BLUE) & ADHESIVE	86	ASSUMED POSITIVE	1,000 S	CLASSROOMS 7-10	(1) (4)	N
M	2' X 4' CEILING PANEL - FISSURE PATTERN	87	ASSUMED POSITIVE	2,600 S	CLASSROOMS 7-10	(1) (4)	N
M	CEMENTITIOUS TRANSITE PANELS	99	ASSUMED POSITIVE	400 S	BELOW EXTERIOR WINDOWS	(1) (4)	N
M	12" ACOUSTIC CEILING TILE - 1/8" HOLE PAT.	105	ASSUMED POSITIVE	400 S	CLASSROOMS 7-10	(1) (4)	N
M	SHEET VINYL FLOORING (CREAM) & ADHESIVE	106	ASSUMED POSITIVE	200 S	MEN'S & WOMEN'S RESTROOMS	(1) (4)	N
M	COVE BASE ADHESIVE	250	ASSUMED POSITIVE	400 L	CLASSROOMS 7-10	(1) (4)	N
M	CARPET ADHESIVE	251	ASSUMED POSITIVE	2,800 S	CLASSROOMS 7-10	(1) (4)	N

Z:\Clients\Chico USD\13-2751 3 Year Reinspections\Sites\Parkview ES\ParkView 6 MONTH.wpd

CONDITION CODE

- General Condition: (1) Good (2) Damaged (3) Significantly Damaged (25% or more)  
Change in Condition: (4) No (5) Yes (If Yes, explain under comments)  
Abated: (6) Repaired (7) Removed (8) Encapsulated (9) Enclosed (10) Isolated & Restricted  
Miscellaneous: (11) Inaccessible, no inspection data (12) Other (Explain under comments) (13) Non-Asbestos/Not Inspected

**CONSULT ORIGINAL AND SUPPLEMENTARY INSPECTION REPORTS FOR MATERIALS WITH TRACE AMOUNTS OF ASBESTOS**

**SIX MONTH SURVEILLANCE  
HOMOGENEOUS ACBM RECORDS**

Date of Inspection: July 31, 2013

District: Chico Unified School District

Inspector: Blake Howes

School: Parkview Elementary School

Building: Unit I - Rooms 914-918

Material Class	Material	Homo. Mat. #	% Asb.	Ft <sup>2</sup> /L.F.	Location	Condition: Code & Comments	Friable Yes/No
S	PLASTER	4	1-5%	1,100 S	BOY'S & GIRL'S RESTROOM WALLS AND CUSTODIAN ROOM	(1) (4) (2) (4) MINOR DAMAGE IN THE CUSTODIAL ROOM.	N
M	DRYWALL	83	ASSUMED POSITIVE	300 S	BOY'S & GIRL'S RESTROOM CEILING	(1) (4)	N

Z:\Clients\Chico USD\13-2751 3 Year Reinspections\Sites\Parkview ES\ParkView 6 MONTH.wpd

**CONDITION CODE**

General Condition: (1) Good (2) Damaged (3) Significantly Damaged (25% or more)

Change in Condition: (4) No (5) Yes (If Yes, explain under comments)

Abated: (6) Repaired (7) Removed (8) Encapsulated (9) Enclosed (10) Isolated & Restricted

Miscellaneous: (11) Inaccessible, no inspection data (12) Other (Explain under comments) (13) Non-Asbestos/Not Inspected

**CONSULT ORIGINAL AND SUPPLEMENTARY INSPECTION REPORTS FOR MATERIALS WITH TRACE AMOUNTS OF ASBESTOS**

**SIX MONTH SURVEILLANCE  
HOMOGENEOUS ACBM RECORDS**

Date of Inspection: July 31, 2013

District: Chico Unified School District

Inspector: Blake Howes

School: Parkview Elementary School

Building: Unit J - Rooms 3-6

Material Class	Material	Homo. Mat. #	% Asb.	Ft <sup>2</sup> /L.F.	Location	Condition: Code & Comments	Friable Yes/No
M	12" VINYL FLOOR TILE (WHITE/BLUE) & ADHESIVE	86	ASSUMED POSITIVE	1,000 S	CLASSROOMS 3-6 AND WORKROOM	(1) (4)	N
M	2' X 4' CEILING PANELS	87	ASSUMED POSITIVE	3,200 S	CLASSROOMS 3-6	(1) (4)	N
M	CEMENTITIOUS TRANSITE PANELS	99	ASSUMED POSITIVE	400 S	BELOW WINDOWS	(1) (4)	N
M	12" ACOUSTIC CEILING TILE	107	ASSUMED POSITIVE	400 S	CLASSROOMS 3-6	(1) (4)	N
M	DRYWALL & JOINT COMPOUND	108	ASSUMED POSITIVE	1,200 S	COPY ROOM AND CUSTODIAL ROOM	(1) (4)	N
M	COVE BASE ADHESIVE	250	ASSUMED POSITIVE	400 L	CLASSROOMS 3-6 & WORKROOM	(1) (4)	N
M	CARPET ADHESIVE	251	ASSUMED POSITIVE	2,800 S	CLASSROOMS 3-6	(1) (4)	N

Z:\Clients\Chico USD\13-2751 3 Year Reinspections\Sites\Parkview ES\ParkView 6 MONTH.wpd

CONDITION CODE

General Condition: (1) Good (2) Damaged (3) Significantly Damaged (25% or more)

Change in Condition: (4) No (5) Yes (If Yes, explain under comments)

Abated: (6) Repaired (7) Removed (8) Encapsulated (9) Enclosed (10) Isolated & Restricted

Miscellaneous: (11) Inaccessible, no inspection data (12) Other (Explain under comments) (13) Non-Asbestos/Not Inspected

**CONSULT ORIGINAL AND SUPPLEMENTARY INSPECTION REPORTS FOR MATERIALS WITH TRACE AMOUNTS OF ASBESTOS**



**SIX MONTH SURVEILLANCE  
HOMOGENEOUS ACBM RECORDS**

Date of Inspection: July 31, 2013

District: Chico Unified School District

Inspector: Blake Howes

School: Parkview Elementary School

Building: Unit K- Rooms 921-925

Material Class	Material	Homo. Mat. #	% Asb.	Ft <sup>2</sup> /L.F.	Location	Condition: Code & Comments	Friable Yes/No
S	PLASTER	3	NONE DETECTED	1,200 S	KITCHEN	(13) REPRESENTED BY SAMPLES HMS-PKV-03A-F COLLECTED ON 4-1-88.	N/A
M	12" VINYL FLOOR TILE (RED) & ADHESIVE	9	1-5%	540 S	KITCHEN (NORTH WEST CORNER)	(1) (4)	N
M	DRYWALL & JOINT COMPOUND	11	ASSUMED POSITIVE	60 S	GIRL'S & BOY'S RESTROOM CEILINGS	(1) (4)	N
M	12" VINYL FLOOR TILE (WHITE/BLUE) & ADHESIVE	92	ASSUMED POSITIVE	1,800 S	MPR, KITCHEN, AND CLOSET ON EACH END OF STAGE	(1) (4)	N
M	9" VINYL FLOOR TILE (BEIGE) & ADHESIVE	101	ASSUMED POSITIVE	200 S	KITCHEN STORAGE	(2) (5) MISSING TILE AND BROKEN TILES.	N
M	COVE BASE ADHESIVE	150	ASSUMED POSITIVE	100 S	MPR AND KITCHEN	(1) (4)	N
S	STUCCO	200	ASSUMED POSITIVE	500 S	COVERED WALKWAYS	(1) (4)	N

Z:\Clients\Chico USD\13-2751 3 Year Reinspections\Sites\Parkview ES\ParkView 6 MONTH.wpd

**CONDITION CODE**

General Condition: (1) Good (2) Damaged (3) Significantly Damaged (25% or more)  
Change in Condition: (4) No (5) Yes (If Yes, explain under comments)  
Abated: (6) Repaired (7) Removed (8) Encapsulated (9) Enclosed (10) Isolated & Restricted  
Miscellaneous: (11) Inaccessible, no inspection data (12) Other (Explain under comments) (13) Non-Asbestos/Not Inspected

**CONSULT ORIGINAL AND SUPPLEMENTARY INSPECTION REPORTS FOR MATERIALS WITH TRACE AMOUNTS OF ASBESTOS**